

Mary. Brown

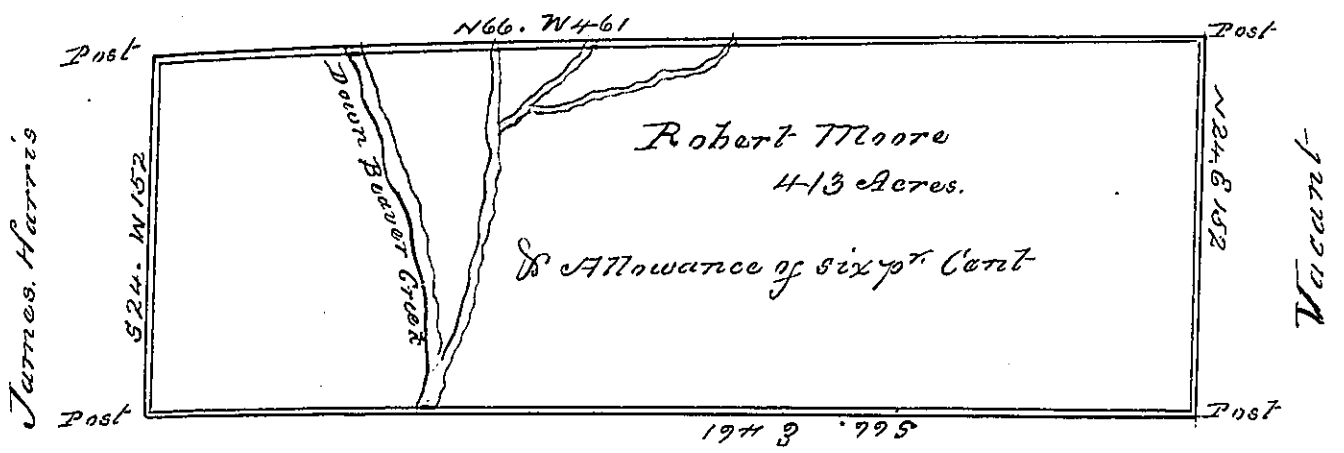

A Draught of a Tract of Land situate on Beaver Creek
 in the County of Bedford. Containing four hundred and thir-
 teen Acres & the Usual Allowance of six p^t Cent for Roads
 Surveyed the 4th day of Nov^r 1784. In Pursuance of a Warrant
 Granted to Robert Moore. Dated July 1st 1784

To John Lukens Esq^r S^r G.

George Woods. D^r S^r

IN TESTIMONY that the above is a copy of the original remaining on file in the
 Department of Internal Affairs of Pennsylvania, made con-
 formably to an Act of Assembly approved the 16th day of
 February, 1833, I have hereunto set my Hand and caused
 the Seal of said Department to be affixed at Harrisburg, this

.....th day of April..... 1891

Thos. J. Stewart
 Secretary of Internal Affairs